

NOTES:

1. All signs and cones to be in accordance with Chapter 8-2009, the TSRGD and current IAN's.
2. Works access and egress are indicative, exact locations to be agreed on site.
3. Safety zones are to be installed as required.
4. All signs to be located so as not to obscure signs or objects and should be ballasted near to ground level using sand filled hessian bags or sign straps.
5. All sign positions are indicative only and must be accurately positioned on site with good visibility and be clear of and obstructions or vegetation at all times.
6. Drawing not to scale
7. TM will comply with the Safety at Street Works and Road Works Code of Practice

Qty: 1 Ref: 13-9-14/R Direction to hazard Right	
Qty: 1 Ref: 2702 Start of temporary diversion route	
Qty: 1 Ref: 517 Road narrows on one side only ahead - left	
Qty: 1 Ref: 573 Direction to hazard left	
Qty: 1 Ref: 573 Direction to hazard right	
Qty: 2 Ref: 510 Keep right	
Qty: 1 Ref: 513 No left turn	
Qty: 2 Ref: 645 End panel	
Qty: 4 Ref: 7001 Road works ahead	
Qty: 2 Ref: 7010-PP-13-9 Nature of temporary hazard ahead - Road Closed	
Qty: 1 Ref: 7010-1 Nature of temporary hazard ahead - Road Ahead Closed	
Qty: 1 Ref: 7105 Lane closure barrier	
Qty: 1 Ref: F202-1 Temporary lane availability	
Qty: 1 Ref: TFL 13-9-NL-DNOC Narrow lanes do not overtake cyclists	

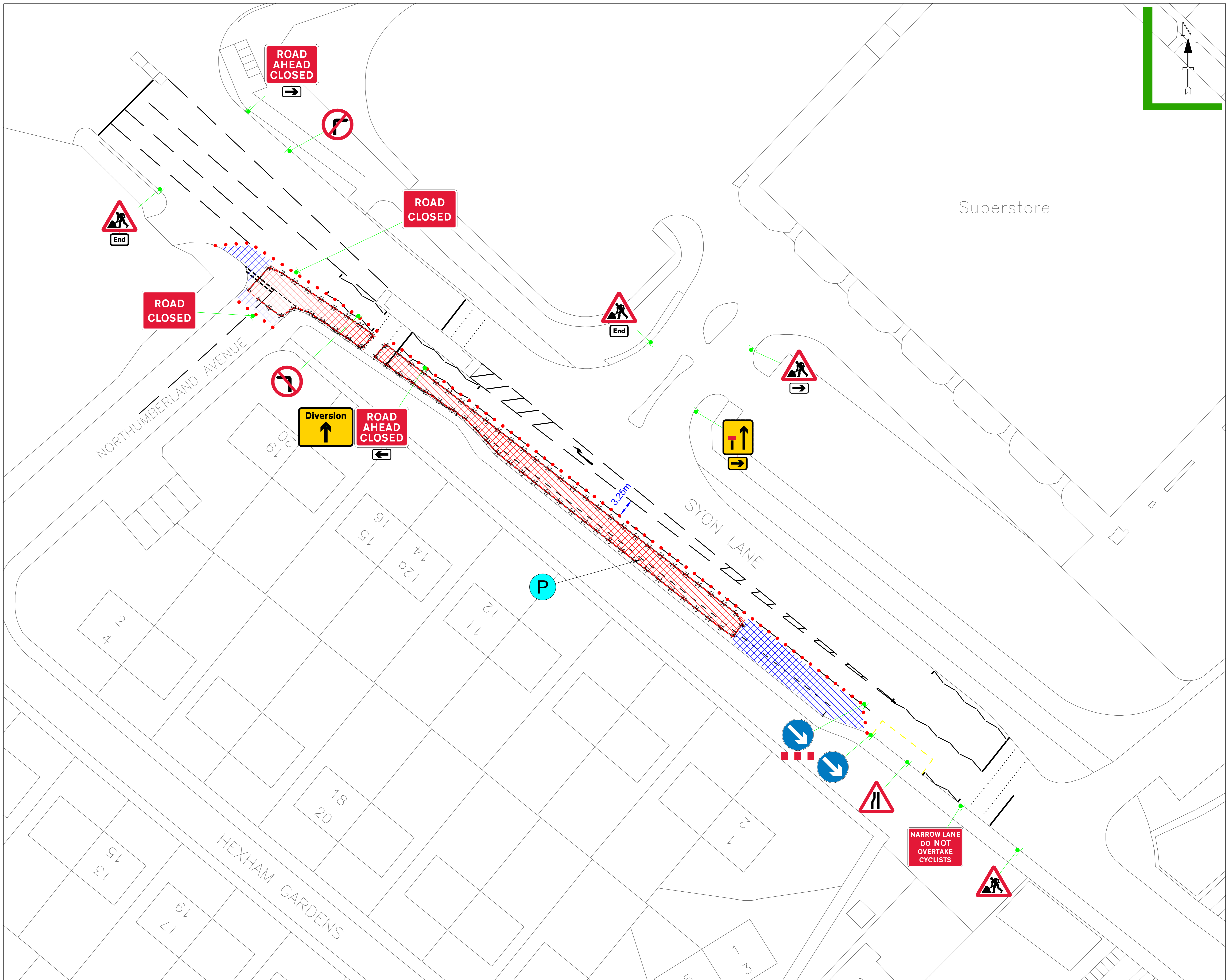
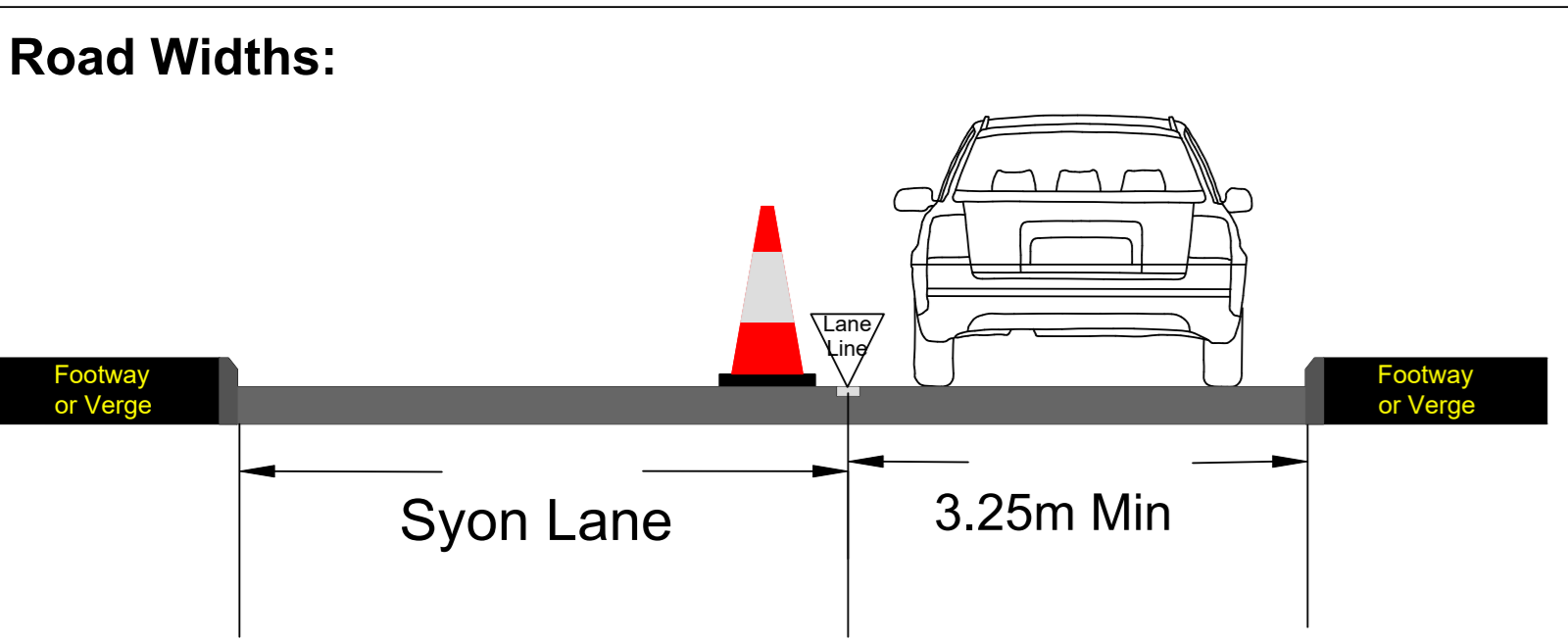

KEY:

	SAFETY ZONE		CONE		Bus stop suspension
	WORK AREA		PED BARRIER		Parking Bay suspension
	SPOIL AREA		NO PARKING CONE		

DETAILS OF THE ROAD

	Syon Lane

Drawn By	M Oprescu	Traffic Management	Lane Closure / Road Closure
Checked By	M Turcanu	Road Name	Syon Lane
Survey By	Client	Borough/Council	Hounslow
Date Drawn	17/02/2026	Postcode	TW7 5QE
Drawing No	IMGA272232		